



# Recreation Center Expansion Project

Grand Park Community Recreation Center



# Grand Park Community Recreation Center

## **3,540-square-foot** Recreation Center Expansion Project

The Grand Park Community Recreation Center (GPCRC) opened its doors on December 18, 2009 to provide citizens and guests of the Fraser Valley a much-needed community center. The GPCRC has not only become a tremendous community asset, it has also become the social hub of the community. The facility has exceeded usage predictions and has been extremely well loved with average daily visits exceeding 400 and annual visits topping 150,000. The GPCRC is also the training facility for the Winter Park Competition Center and the National Sports Center for the Disabled athletes and coaches.

In 2017, the Fraser Valley Metropolitan Recreation District (FVMRD) adopted the Parks, Recreation & Golf Master Plan that identified expanding the GPCRC amenities as a high priority. It also recommended that the FVMRD conduct a feasibility study to determine cost of expansion and potential programming opportunities. In 2019, the FVMRD engaged Perkins+Will, the original architectural firm, to develop a conceptual design and estimated budget for a fitness area expansion.

An expansion of the second floor fitness area is needed to address capacity issues and the growing demand for fitness, functional and designated team training space. The GPCRC expansion would provide an additional 3,540 square feet, split into five distinct areas. Included in the design is a new High Intensity Interval Training (HIIT) studio for sports team training and specialized workouts, an athletic performance testing consultation room, a new group exercise studio w/ modular equipment storage, and expanding of the existing free weight area. The project will include an expansion of administration office space, that will allow us to accommodate three additional full-time staff. The project will also include a 112kW photovoltaic solar system. It would also allow us to increase fitness opportunities to improve our community's health and wellness.

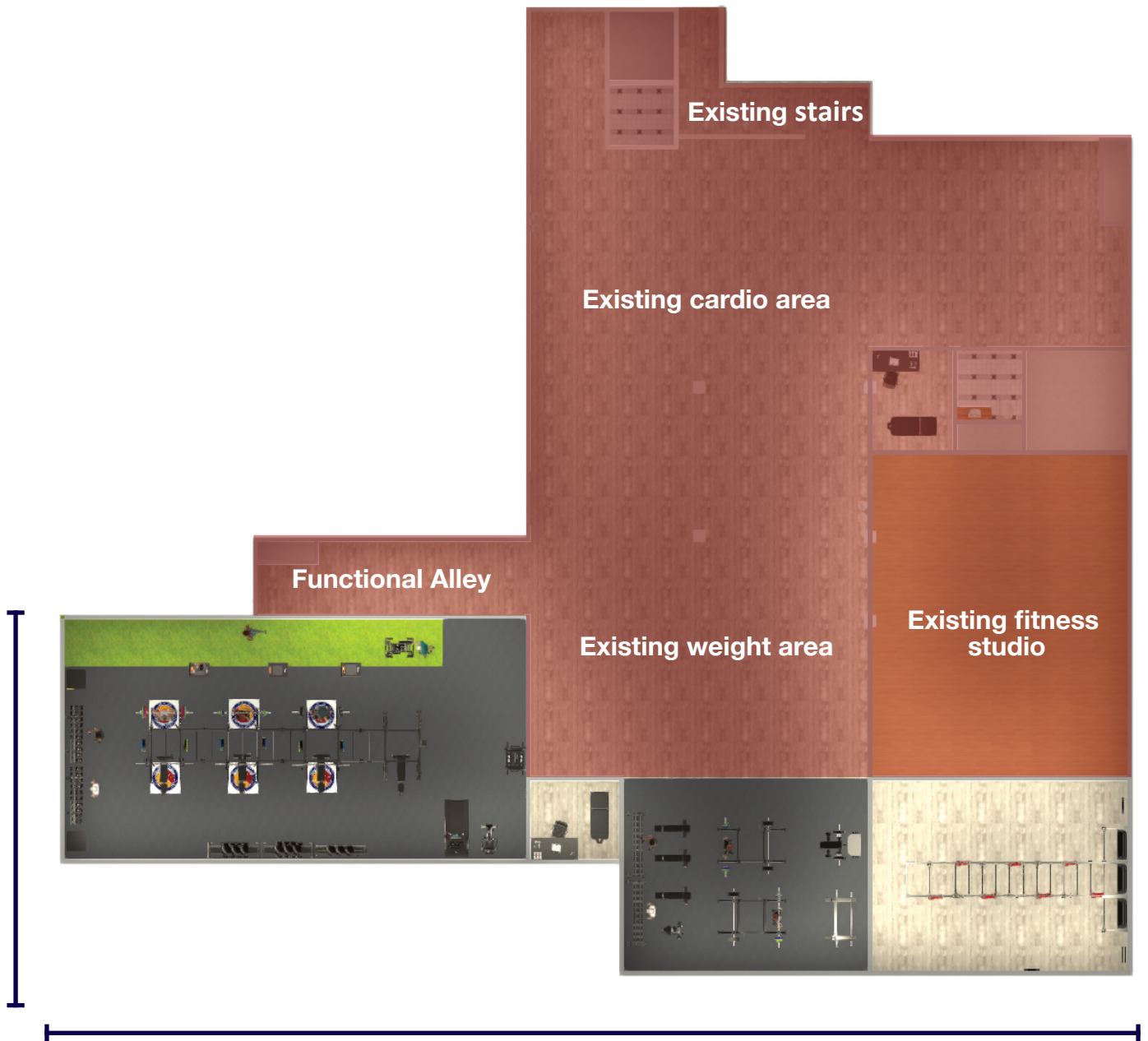

**3,290 -square-foot fitness expansion**





**NEW 1700 square ft High Intensity Interval Training (HIIT) Studio**

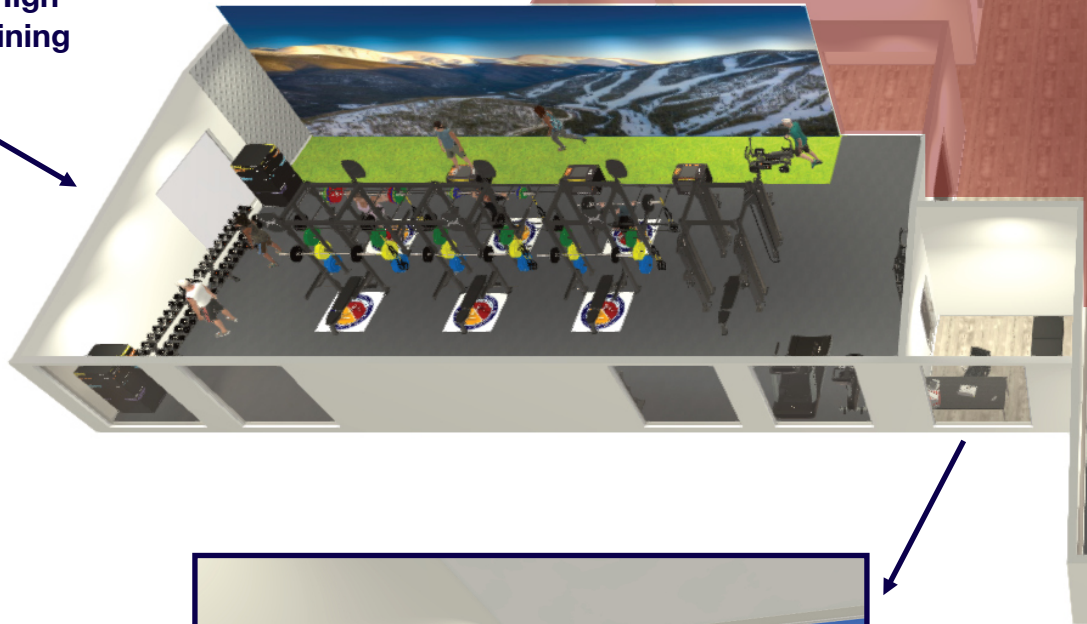

**NEW Wellness Evaluation Room**



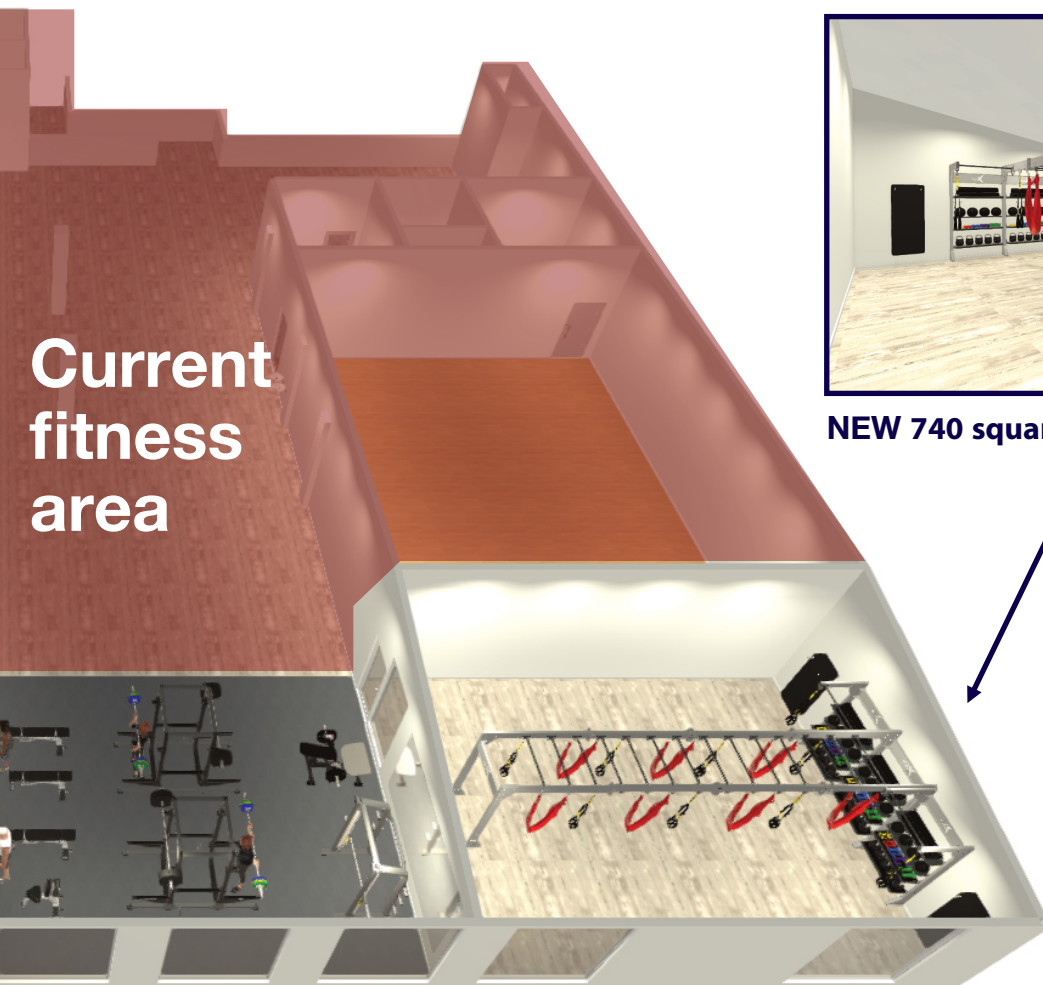

**Current  
fitness  
area**



**NEW 740 square ft Group Exercise Studio**

**Expansion of current fitness  
center by 850 square feet**



## NEW 1700 Square Ft High Intensity Interval Training (HIIT) Studio



## Expansion of current fitness center by 850 square feet



## NEW 740 Square Ft Group Exercise Studio



## Plan Description

Interior finish upgrades including new fitness flooring, paint, LED light fixture replacement. An addition on existing balcony slab designed for floor loading.

Removal of roofing and drainage, new construction of 3,540 square feet of interior fitness space would increase current space by 60%. This would include:

- New 1700 square foot high intensity training (HIIT) studio for specialized workouts, strength, functional and team training space.
- Expansion of the existing fitness center by 850 square feet for additional equipment and open plyometric and resistance training
- New 740-square-foot group exercise studio with resilient wood flooring, mirrors and modular equipment storage.
- 150 square ft Administration Office Space and a Solar Array 112kW instillation

## Cost Summary

3,540 square-foot addition

<b>Soft Costs</b> <i>(Architectural Fees, Permits etc.)</i>	\$ 105,000
<b>Construction Costs</b>	
<i>High Intensity Interval Training Studio</i>	\$ 850,000
<i>Free Weight Area Expansion</i>	\$ 425,000
<i>Group Exercise Studio</i>	\$ 370,000
<i>Wellness Evaluation Room</i>	\$ 60,000
<i>Administration Offices</i>	\$ 75,000
<i>Fitness Flooring &amp; Equipment Project</i>	\$ 194,280
<i>Solar Array - 112kW</i>	\$ 301,000
<i>Contingency</i>	\$ 227,745
<b>TOTAL</b>	<b>\$ 2,608,025</b>



# Donate Today

I would like to support the Fraser Valley Recreation Foundation in providing the opportunity to expand the Grand Park Community Recreation Center Fitness area to meet our growing community. If you would like to donate in another manor, ie. in-kind or stock donations, please contact us directly.

Your donation is tax deductible and you will receive a donation receipt.

☐ \$5,000

☐ \$10,000

☐ \$15,000

☐ I would like to make a donation of...

---

## ***Donor Recognition***

*We are working on designing an on-site permanent display to recognize our "Heavy Weight" donors and celebrate our generous supporters.*

---

**Please make check payable to Fraser Valley Recreation Foundation and mail your donation to the:**

Fraser Valley Recreation Foundation  
PO Box 1331 Winter Park, CO 80482

*For additional information please contact  
[scott@fraservalleyrec.org](mailto:scott@fraservalleyrec.org)*



*It is the mission of the Fraser Valley Recreation Foundation to solicit, collect and manage contributions including, monetary, real and personal property. These contributions shall be used to initiate, support and continue recreational programs, cultural events, health and wellness projects and education opportunities for the benefit and enjoyment of residents and visitors of the Fraser Valley, as well as, support and maintain venues and facilities used for these opportunities. Funds shall also be used to offer scholarships and financial assistance to Grand County residents for access to these opportunities.*